

Rubex

Parts and Instructions

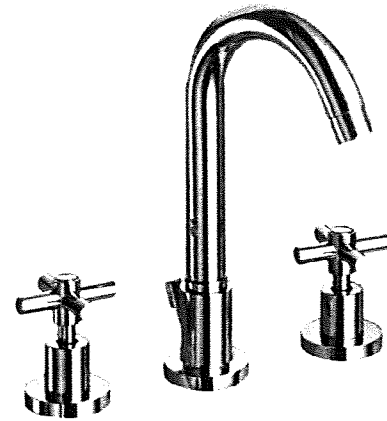
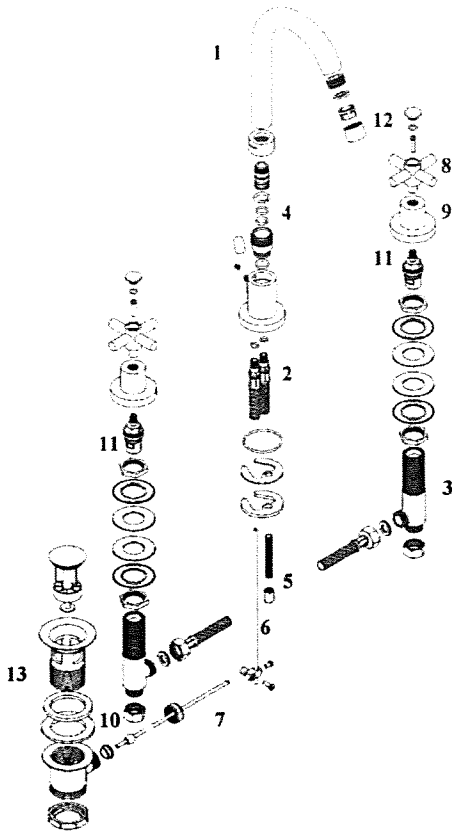

708 SERIES

Part No. Description

1	708-1040	Spout
2	N088	Supply Lines
3	820-1053	Valve Body
4	820-1058C	Cone Packing & Nut
5	708-090	Lift Rod Washer & Nut
6	708-092	Lift Rod
7	820-091	Lift Rod Connection to Pop-up
8	700-6200	Cross Handles
9	700-1055F	Handle Flanges
10	708-6	Coupling Nut
11	700-00034RC	Cold Cartridge
	700-00034RH	Hot Cartridge
12	700-1065	Aerator 8.3 LPM (2 GPM)
13	820-1015	Pop-up Waste Assembly

Note: -Above Part Numbers for Chrome Finish
-Please Note Faucet Finish When Ordering Parts

Care and Maintenance

Minimum maintenance is required to maintain product finish. With proper maintenance your **Rubex** faucet will continually look like new. Special care should be taken when cleaning your Faucet and the following suggestions should help extend your Faucet life.

A) Cleaning should be done regularly using a soft cotton cloth and warm water; then towel dry.

B) Do not use cleaners that contain abrasives or harsh chemicals; care should be taken in selecting cleaning supplies. Many cleaners contain detergents, ammonia, or other corrosive solvents that could damage your faucet finish.

C) Occasionally clean with a non-abrasive wax polish.

Warranty

TAIC warrants the original purchase for a Limited Life Time Warranty from original date of purchase that the product will be free of any manufacturing defects. Product will be replaced at no charge provided it has been installed in accordance to **TAIC Installation Instructions**, used as recommend and not damaged due to misuse, abuse, faulty maintenance, accident or other damage. TAIC is not responsible for replacement labor costs, or shipping charges, or damage incurred during installation, removal, repair, or replacement of any TAIC product.

Imported by:
Trans-Atlantic Import Co. Inc.
Toll Free 1-800-661-8295
Email: taic@incentre.net